

KATES, TOM

05

PATEL  
c/o WILSON & KATES, P.C.  
108 SOUTH MAIN STREET  
P.O. BOX 266  
SCOTTVILLE, MICHIGAN 49454

# MORTGAGE INSPECTION

### DESCRIPTION:

LOTS 8, 9 & 10 OF  
COUNTY, MICHIGAN.

OF THE ORIGINAL PLAT OF THE CITY OF LUDINGTON, MASON

PROPERTY ADDRESS:  
VENTURA MOTEL  
W. LUDINGTON AVENUE  
LUDINGTON

A POTENTIAL ENCROACHMENT MAY EXIST WITH THE SHED. IF IT IS DESIRED TO DETERMINE THE EXISTENCE AND DEGREE OF THE ENCROACHMENT, A PROPERTY SURVEY IS RECOMMENDED.

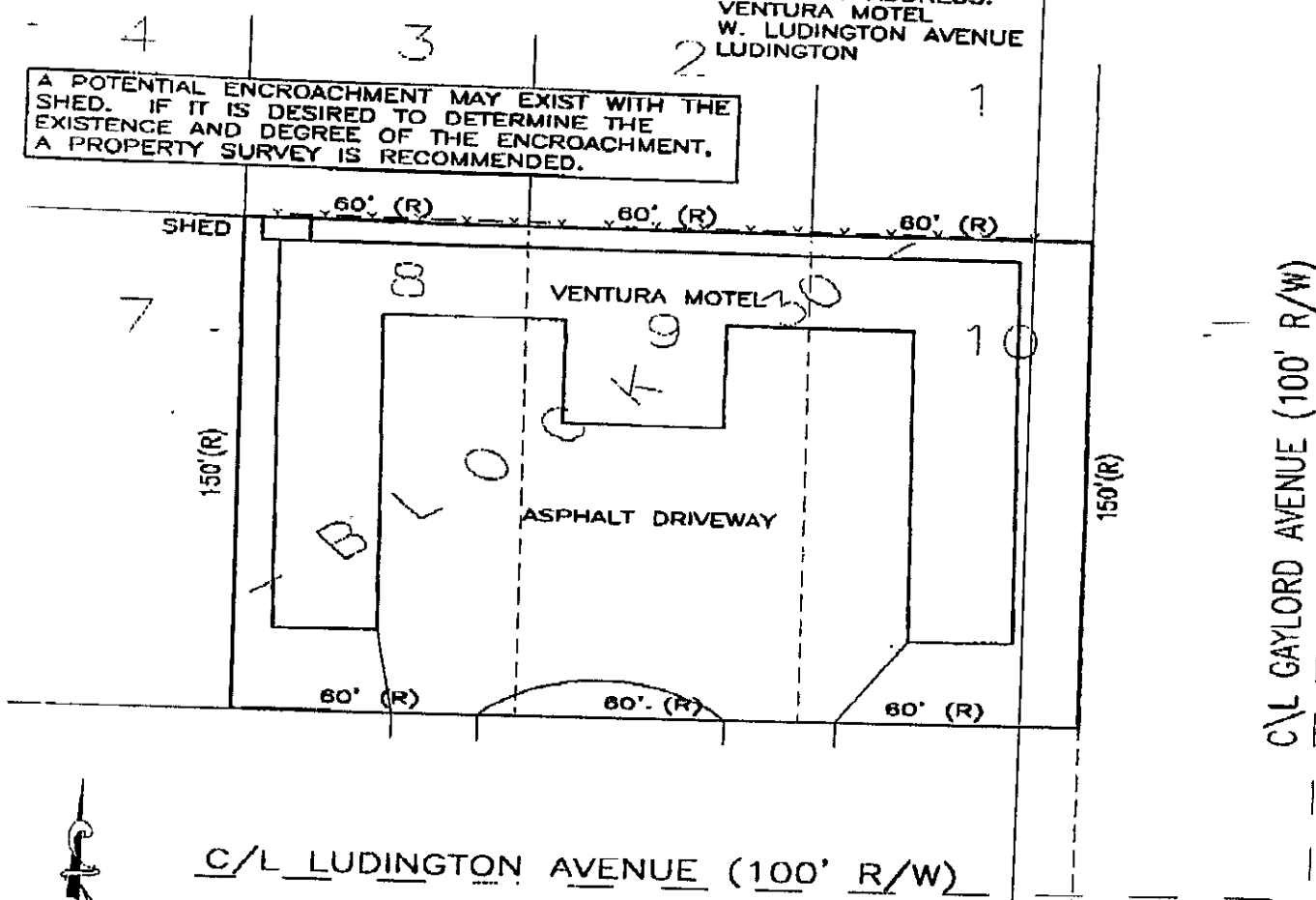

C/L LUDINGTON AVENUE (100' R/W)

C/L GAYLORD AVENUE (100' R/W)

SCALE: 1" = 40'

- LEGEND**
- O - FOUND CORNER
  - - SET CORNER
  - ⊙ - FOUND MONUMENT
  - ⊠ - SET MONUMENT
  - R - RECORDED
  - M - MEASURED

I HEREBY DECLARE THAT THE PROPERTY AS DESCRIBED AND SHOWN HEREIN HAS BEEN INSPECTED AND THAT TO THE BEST OF MY PROFESSIONAL KNOWLEDGE AND BELIEF, THE BUILDINGS AND IMPROVEMENTS ARE LOCATED AS SHOWN AND THAT THERE ARE NO VISIBLE ENCROACHMENTS UPON SAID PROPERTY UNLESS NOTED AND SHOWN. THIS INSPECTION WAS PREPARED FOR IDENTIFICATION PURPOSES ONLY AND IS NOT INTENDED OR REPRESENTED TO BE A LAND OR PROPERTY LINE SURVEY. NO PROPERTY CORNERS WERE SET. THIS MORTGAGE INSPECTION IS NOT TO BE RELIED UPON TO ESTABLISH A FENCE, BUILDING OR OTHER IMPROVEMENTS.

FILE: MS-01-237  
DATE: OCTOBER 11, 2001

*James T. Nordlund*  
Registered Surveyor

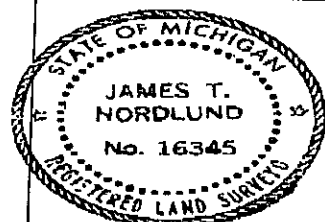

Providing Complete  
Engineering & Surveying  
Services since 1972

**Nordlund & Associates Inc.**  
225 E. Ludington Ave.  
Ludington, MI 49401  
(616) 848-8400  
(616) 848-7576 Fax Number  
287 River Street  
Marquette, MI 49801  
(228) 728-8480